



PRODUCT SPECIFICATION

PROIP



INTRODUCTION

The ProIP offers a covered and sealed product where clients demand the combination of a sensor controlled, energy efficient, low maintenance luminaire with ease of cleaning and protection against dust and water ingress. The ProIP is available in both IP20 variants, where a covered luminaire is required for ease of cleaning, and IP65 variants where complete protection is required from dust and water. With a range of integral sensor options and highly efficient LEDs and drivers the ProIP offers excellent return on investment in a range of arduous applications such as food production and manufacturing.

With two sensor options, the R11 sensor offering presence and the R44 sensor offering both presence detection, daylight regulation and mounting heights of 2.5m to 16m depending on the sensor type, the ProIP can be tailored to ensure the most effective solution possible for your project. With an integral sensor in each luminaire there is no need to modify external wiring allowing for rapid and low cost installation.

All sensor options in the ProIP range are compatible with the Dexeco REA-AP controller offering simple ground level programming allowing for quick and simple reconfiguration of sensors when required. The ProIP is also available with integral lithium emergency helping to ensure the safety of your workplace. We offer a range of wireless control systems providing localised grouping and control as well as comprehensive wireless solutions allowing both standard and emergency luminaires to be centrally monitored.

UK CA	CE	IP40	IP65	TM21: L90>60K Hours / L80>90K Hours	3 STEP MACADAM ELLIPSE
----------	----	------	------	--	---------------------------

APPLICATION

- Food / Clean Area
- Industrial / Manufacturing
- Transport
- Warehouse / Storage

SPECIFICATION

CONSTRUCTION

- Housing: 0.7mm CR4 steel
- Finish: Polyester powder painted BS 00E55 matt white 60% gloss
- Endcaps: Injection moulded polycarbonate
- Diffuser: 2mm clear polycarbonate
- IP40
- IP65

PERFORMANCE

- Part L2 compliant
- 3SCDM Three step Macadams ellipse
- TM21: L90>60K Hours / L80>90K Hours
- Up to 142 luminaire lumens per circuit Watt.

ENVIRONMENTAL

- Designed to allow simple replacement of components with commonly available tools in compliance with the Eco Design Directive, please see the installation leaflet for maintenance instructions.
- Powered by European branded drivers and emergency modules ensuring replacement parts are easily sourced.
- Every luminaire is labelled with a unique ID number allowing easy identification of spare parts for the lifetime of the product.
- Contains no single use plastics or polystyrene packaging.
- Supplied in plain card boxes with paper tape ensuring packaging is easily recycled.
- Designed to allow simple disassembly for end of life recycling.
- UK based manufacturing providing local support throughout the product lifetime and minimising transportation miles.

EMERGENCY

- Available with optional standard, self test and autotest integral emergency with lithium batteries for extended warranty and lifetime.
- Optional Reacta-Link wireless emergency for automated centralised reporting.
- Optional Reacta-Control wireless emergency for automated centralised reporting.
- Optional central battery changeover relay

CONTROL

- Optional compatibility with a range of dimming systems including DALI, DSI and Switch Dimming
- Optional Integral R11 presence sensor
- Optional Integral R44 presence and daylight sensor
- Optional Integral Reacta-Air wireless presence and daylight regulations sensor
- Optional integral Reacta-Link for integration with Reacta-Link wireless installations
- Ground level commissioning with REA-AP controller allows quick and simple setting and adjustment of sensors without the need for costly commissioning.
- Ground level commissioning with the user friendly REA-AP remote control eliminates the need for expensive commissioning and enables quick and simple adjustment of settings as required on site.

INSTALLATION

- Suitable for suspended installation
- Suitable for trunking installation

VARIATIONS

- Available with a wide range of colour temperatures and renderings
- Available in a range of housing sizes and lumen outputs

IMAGES

PRODUCT IMAGES



ProIP IP65



ProIP IP20

PROJECT IMAGES

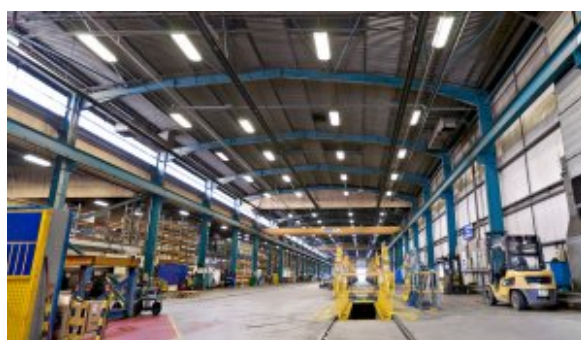

TECHNICAL

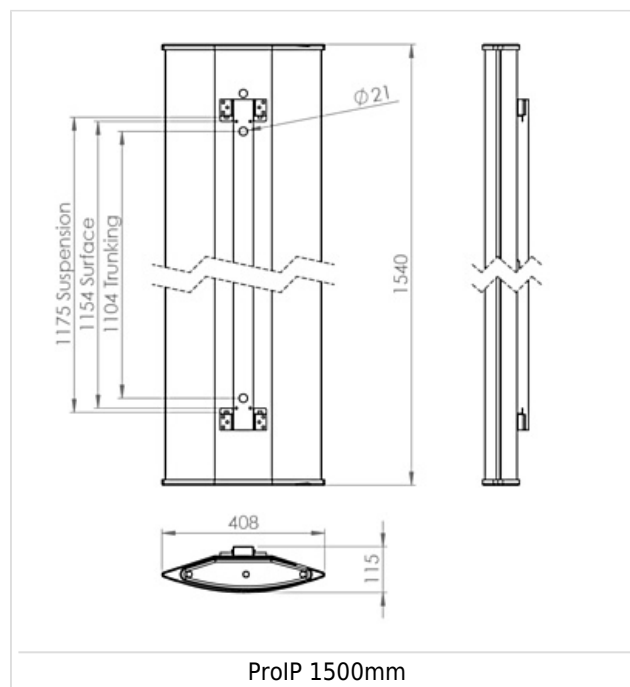
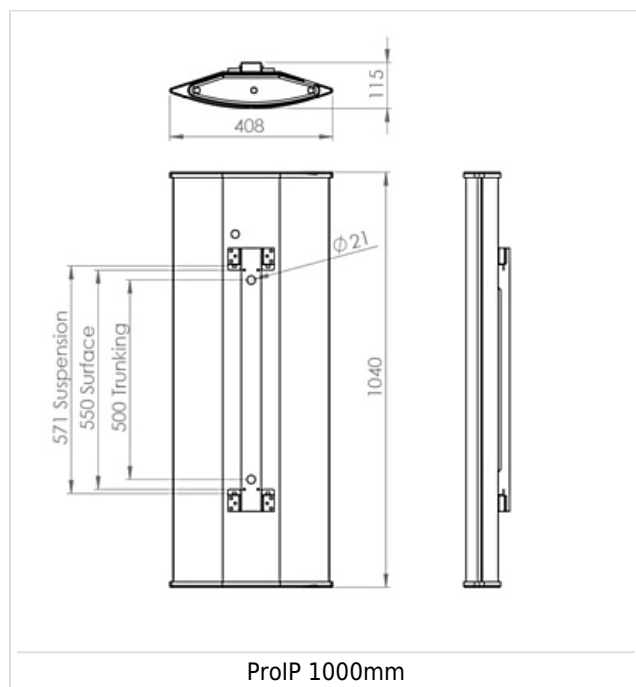

WARRANTY

At Dextra our commitment to service has been at the forefront throughout our history spanning more than forty years in the UK lighting market. Our service ethos extends beyond design and delivery, we believe supporting your installation throughout the warranty period is equally crucial, whilst the strength and longevity of Dextra Group provides peace of mind that our warranty will be supported throughout.

The Dextra range is supplied with a five year warranty commencing from the date of delivery. During the first three years defects will be repaired on site and the warranty will include both parts and labour. For the final two years drivers, emergency modules, wireless modules, sensors and LED circuits will be supplied free of charge to replace defective components, labour and other associated costs are not included.

Certain ranges and components are subject to exemptions:

- Lithium batteries are provided with a three year warranty for parts and labour. Nickel Metal Hydride and Nickel Cadmium batteries are provided with a one year warranty for parts and labour.
- Emergency luminaires including AME LED, EXI LED, EXI2 LED, EXI Track, HBE LED, HBE2 LED, OAT2 LED, OEZ LED and Twinspot with Nickel Metal Hydride batteries are supplied with a one year warranty for parts and labour. Lithium variants of these ranges are supplied with a three year warranty for parts and labour with the exception of the AME2, EXI3, HBE3 and TWS IP65 L7 ranges which are supplied with a one year parts and labour warranty. TWS IP65 L7 in autotest and wireless variants are supplied with the standard three year lithium battery warranty.
- Protec Micro, PTECF7 Fire Rated Downlights, Serenus and the Opus Sconce are provided with a five year replacement luminaire only warranty. Protec FR Fire Rated Downlights are provided with a 2 year replacement luminaire only warranty.

- Controls systems such as standalone sensors, switches, marshalling boxes and cabling are provided with a one year warranty for both parts and labour. DALI control systems are provided with a two year warranty for both parts and labour.
- LEDextra ranges are supplied with a three year parts or replacement luminaire only warranty with the exception of the IMPR RGBW, the Runway RGBW and the MOD RGBW. These three ranges are supplied with our standard five year warranty during which defects within the first three years will be repaired on site and the warranty includes both parts and labour. For the final two years free of charge replacement components only will be supplied to rectify any failures but labour and other associated costs are not included.
- LEDEX ranges are supplied with a three year replacement luminaire only warranty.

All warranties are subject to correct use of the product and will be invalidated by misuse, for example incorrect installation, unsuitable environmental conditions or incorrect maintenance. It is the duty of the customer to ensure that all the fault lies with the luminaire prior to requesting replacement parts or site repairs. In the event that no defect is found with the product our costs for attending site will be recharged to the customer and credit will not be issued against returned products. No consequential losses incurred resulting from any defect with our product will be reimbursed.

Given the nature of LED technology a small percentage of LEDs may fail during the lifetime of a luminaire, this does not cause a reduction in lumen output. As such LED luminaires are only deemed to be faulty for warranty purposes when in excess of ten percent of LEDs have failed in a single luminaire

On site repair of products under warranty will be undertaken during normal working hours, 9am to 5pm Monday to Friday, and will require unrestricted access to luminaires. Where required Dextra will provide access equipment to carry out repairs at height, should luminaires have been installed in locations where reasonable provision for maintenance access has not been made we reserve the right to supply replacement product only.

If you require any assistance with regards to our products please contact our Customer Services department on 01747 858100.

[DOWNLOAD WARRANTY PDF](#)

ORDER CODES

LUMINAIRE

IP20

Code	Description	Power	Llm/W
PRO L170	ProIP, 1000mm, 13,466lm, Colour 84	95.9W	140
PRO L240	ProIP, 1000mm, 19,037lm, Colour 84	138.4W	139
PRO L345	ProIP, 1500mm, 27,740lm, Colour 84	199.9W	139

IP65

Code	Description	Power	Llm/W
PRO65 L170	ProIP, 1000mm, 13,664lm, Colour 84	95.9W	142
PRO65 L240	ProIP, 1000mm, 19,176lm, Colour 84	138.4W	139
PRO65 L345	ProIP, 1500mm, 26,839lm, Colour 84	199.9W	134

DIMMING

Code	Description
A	DALI Digital Addressable Lighting Interface
S	Switch Dimming
D	DSI Digital Dimming
H	HFR Analogue 1-10v

CONTROL

Code	Description
R11	Reacta 11, Presence, IP65, Low Temperature, 3-15M
R44	Reacta 44, Presence & Daylight, 2.5-7M
RLI	Reacta-Link, Wireless Enabled Luminaire
RLS	Reacta-Link Wireless, Presence, 2.5-4M
RLS10	Reacta-Link Wireless, Presence, 5-10M
RLS15	Reacta-Link Wireless, Presence, 10-15M
RCS	Reacta-Control Wireless, Presence, Daylight, 2.5-4M
RCS18	Reacta-Control Wireless, Presence, Daylight, 8-18M

Please click [here](#) for full details on our wireless controls.

EMERGENCY

Code	Description
LE3	Lithium Standard Emergency 3 Hour
LS3	Lithium Selftest Emergency 3 Hour
LA3	Lithium Autotest Emergency 3 Hour
LSTR	Lithium Reacta-Link Emergency 3 Hour
LA3RC	Lithium Reacta-Control Emergency 3 Hour
CB	Central Battery, Please Specify 50V, 110V or 230V when Ordering

In IP65 variants, emergency is only available in L170 1000mm variants and L240 1500mm variants.

MISCELLANEOUS

Code	Description
C**	Select Colour Temperature and Rendering; C83, C84, C85, C865, C93, C94
LSF	Low Smoke Zero Halogen