



PRODUCT SPECIFICATION

RUNWAY CONTINUOUS RECESSED



INTRODUCTION

Where lighting must fulfill both architectural and practical purposes the Recessed Runway provides a seamless appearance that can be infinitely reconfigured to dramatic effect. A slim line aluminium housing available in three colour options, offering the versatility to be recessed in continuous runs combined with corner sections in a range of lengths and lumen outputs ensures that you can create a layout that enhances any space creating an attractive environment for workers or enticing potential customers.

This flexibility is further enhanced with integral emergency, white tunable and dimming options and two optic styles, a minimalist opal finish or microprism for compliance with the 3000 candela requirements of BSEN12464 for use in office and school areas (L22 and L14 variants only). The Runway also incorporates the latest mid power LEDs ensuring optimal energy efficiency with minimal need for maintenance over the course of its lifetime.

The Runway is also available in a range of standalone and surface or suspended options where required.

- CE
- IP20
- L90 / 60K OPERATING HOURS
- 3 STEP MACADAM ELLIPSE

APPLICATION

- Education

- Office
- Retail

SPECIFICATION

CONSTRUCTION

- Extruded aluminium trunking with three colour options.
- Die cast aluminium end caps.
- High transmission opal diffuser with optional microprism insert for BSEN 12464 3000 candela compliance (L22 and L14 variants only).
- Suitable for recessed installation.

PERFORMANCE

- Available in a wide range of lumen packages including glare compliant versions compliant with BSEN12464 3000 candela requirement.
- Philips Lumileds LM80 verified: 90% LED lumen maintenance at 60,000 operating hours.
- Standard Deviation Colour Match – 3 Step Macadam's Ellipse.

CONTROL

- Available with DALI, Digital Dimming, Analogue Dimming and Switch Dimming.
- White Tunable, Lumen outputs vary, please contact our sales department for details.

EMERGENCY

- Available with optional standard, self test and autotest emergency integral control gear.

INSTALLATION

- Trunking sections available in 1000mm, 1500mm and 3000mm lengths.
- Gear trays in 1500mm and 1000mm with quick release clips for ease of installation into trunking system.
- All trays supplied complete with 6 core 1.5mm through wire loom.
- Available in a range of lengths from 1000mm to 1500mm to allow the run length to be customised to the room size.

VARIATION

- Where reversed corners are required to achieve the desired configuration these are available on special request. Detailed information of the installation method will be required to ensure we provide the correct solution.

IMAGES

PRODUCT IMAGES



Runway Continuous Recessed in Grey



Sensor for Runway Recessed



Runway Continuous Recessed in Grey with eay air

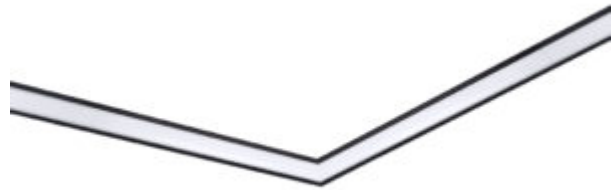

Runway Continuous Recessed in Black



Runway Continuous Recessed in White

PROJECT IMAGES



TECHNICAL

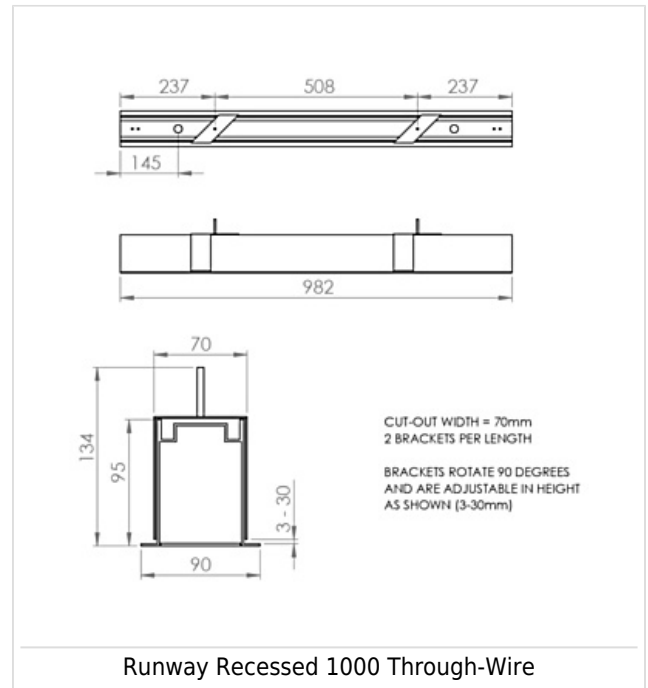
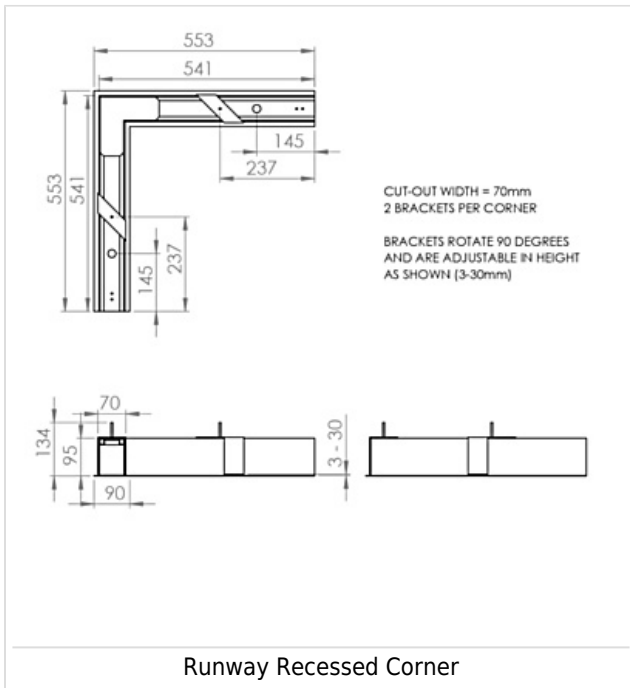

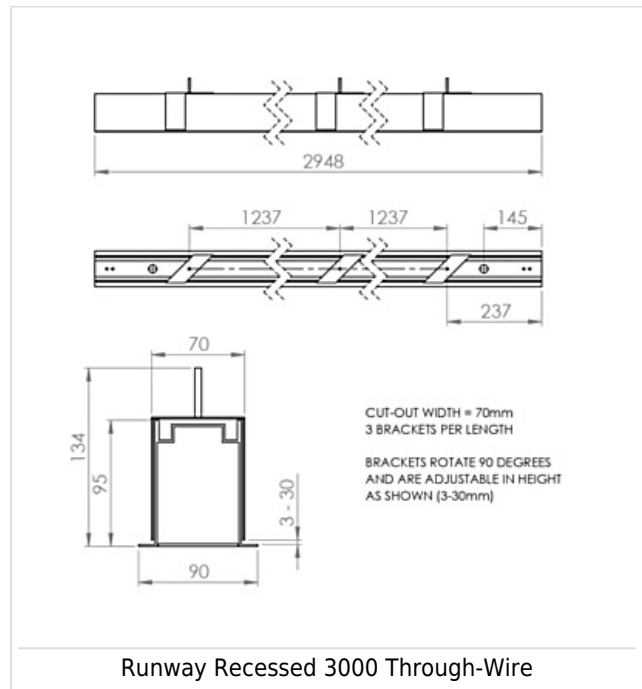
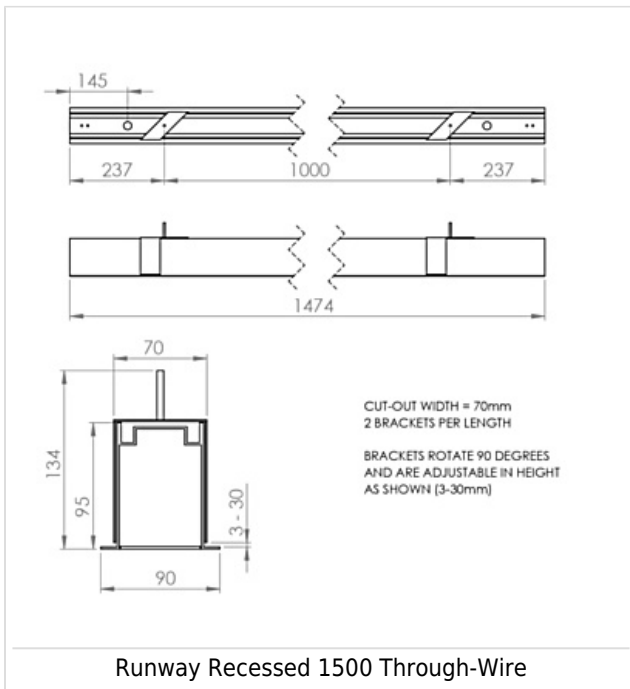

WARRANTY

5 year warranty on LED product ranges is subject to a maximum of 4000 operating hours per year and only applies where failures exceed the component manufacturers expected failure rate and lumen depreciation.

extra products are supplied with a 12 month warranty for any defect that may occur with the product during this time. Any defect will either be repaired on site free of charge or the defective product may be replaced on a chargeable basis and credit given against defective product returned. The course of action taken will be at our discretion and dependent on the nature of the defect.

The control gear within our high frequency and LED luminaires is further underwritten by our suppliers for a period of up to 5 years in total from the time of purchase. This comprises labour and parts for the first 3 years and free of charge components only for the final 2 years.

PROTEC LED FR 8W GU10 luminaires and all Emergency LED ranges such as LED 3, EXI, HBE, OAT, O EZ, AME, OEH and TWS * are exempt from the 5 year warranty and are supplied with 1 year warranty only. PROTEC LED COB luminaires are supplied with a three year warranty for replacement luminaires only.

Glide Power, Glide Mini, Glide RGBW, Colour Glide and Glide In Ground ranges are supplied with a three year parts or replacement luminaire only warranty.

All warranties are subject to correct use of the product and will be invalidated by misuse, for example incorrect installation or unsuitable environmental conditions.

It is the duty of the customer to ensure that all relevant tests have been carried out prior to requesting site visits or replacement products, for example replacement of lamps, commissioning of sensors and inspection of external wiring. In the event that no defect is found with the product our costs for attending site will be recharged to the customer and credit will not be issued against returned products.

No consequential losses incurred resulting from any defect with our product will be reimbursed.

Consumable commodities such as lamps, starters and batteries are excluded from these warranty terms. Batteries are supplied with a twelve month warranty only.

5 year warranty on LED product ranges is subject to a maximum of 4000 operating hours per year and only applies where failures exceed the component manufacturers expected failure rate and lumen depreciation.

If you require any assistance with regards to our products please do not hesitate to contact our Customer Services department on 01747 858100.

*The LED4 Emergency LED range is supplied with a three year battery warranty and 5 year luminaire warranty.

ORDER CODES

LUMINAIRE CODES

Code	Description	Circuit Wattage Llm/W	
RECESSED CONTINUOUS RUN TRUNKING			
RWYR 1000 ST GREY	Runway Trunking, 1000mm, Recessed, Grey, Start		
RWYR 1000 TW GREY	Runway Trunking, 1000mm, Recessed, Grey, Through Wire and End of Run		
RWYR 1500 ST GREY	Runway Trunking, 1500mm, Recessed, Grey, Start		
RWYR 1500 TW GREY	Runway Trunking, 1500mm, Recessed, Grey, Through Wire and End of Run		
RWYR 3000 ST GREY	Runway Trunking, 3000mm, Recessed, Grey, Start		
RWYR 3000 TW GREY	Runway Trunking, 3000mm, Recessed, Grey, Through Wire and End of Run		
CONTINUOUS RUN GEAR TRAY			
Low Output			
1000mm			
*RWY 1000 L14 TW	Runway Gear Tray, 1000mm, 871lm, Through Wire, Colour 84	9.5W	91
*RWY 1000 L14 ER	Runway Gear Tray, 1000mm, 871lm, End of Run, Colour 84	9.5W	91
1500mm			
*RWY 1500 L22 TW	Runway Gear Tray, 1500mm, 1519lm, Through Wire, Colour 84	13.9W	109
*RWY 1500 L22 ER	Runway Gear Tray, 1500mm, 1519lm, End of Run, Colour 84	13.9W	109
Corner			
**RWYR COR L14 TW MP GY	Runway Gear Tray, 90 Degree Corner, 868lm, Recessed, Microprism Diffuser, Through Wire, Grey, Colour 84	9.9W	87
**RWYR COR L14 ER MP GY	Runway Gear Tray, 90 Degree Corner, 868lm, Recessed, Microprism Diffuser, End of Run, Grey, Colour 84	9.9W	87
Medium Output			
1000mm			
RWY 1000 L20 TW	Runway Gear Tray, 1000mm, 1331lm, Through Wire, Colour 84	13.6W	97
RWY 1000 L20 ER	Runway Gear Tray, 1000mm, 1331lm, End of Run, Colour 84	13.6W	97
1500mm			
RWY 1500 L30 TW	Runway Gear Tray, 1500mm, 2221lm, Through Wire, Colour 84	18.8W	118
RWY 1500 L30 ER	Runway Gear Tray, 1500mm, 2221lm, End of Run, Colour 84	18.8W	118
Corner			
RWYR COR L20 TW OP GY	Runway Gear Tray, 90 Degree Corner, 1330lm, Recessed, Opal Diffuser, Grey, Through Wire, Colour 84	13.2W	100
RWYR COR L20 ER OP GY	Runway Gear Tray, 90 Degree Corner, 1330lm, Recessed, Opal Diffuser, Grey, End of Run, Colour 84	13.2W	100

RWYR COR L20 TW MP GY	Runway Gear Tray, 90 Degree Corner, 1235lmm, Recessed, Microprism Diffuser, Grey, Through Wire, Colour 84	13.2W	93
RWYR COR L20 ER MP GY	Runway Gear Tray, 90 Degree Corner, 1235lmm, Recessed, Microprism Diffuser, Grey, End of Run, Colour 84	13.2W	93
High Output			
1000mm			
RWY 1000 L30 TW	Runway Gear Tray, 1000mm, 2000lmm, Through Wire, Colour 84	20W	100
RWY 1000 L30 ER	Runway Gear Tray, 1000mm, 2000lmm, End of Run, Colour 84	20W	100
1500mm			
RWY 1500 L45 TW	Runway Gear Tray, 1500mm, 3331lmm, Through Wire, Colour 84	28.3W	117
RWY 1500 L45 ER	Runway Gear Tray, 1500mm, 3331lmm, End of Run, Colour 84	28.3W	117
Corner			
RWYR COR L30 TW OP GY	Runway Gear Tray, 90 Degree Corner, 1999lmm, Recessed, Opal Diffuser, Through Wire, Grey, Colour 84	19.3W	103
RWYR COR L30 ER OP GY	Runway Gear Tray, 90 Degree Corner, 1999lmm, Recessed, Opal Diffuser, End of Run, Grey, Colour 84	19.3W	103
RWYR COR L30 TW MP GY	Runway Gear Tray, 90 Degree Corner, 1857lmm, Recessed, Microprism Diffuser, Grey, Through Wire, Colour 84	19.3W	96
RWYR COR L30 ER MP GREY	Runway Gear Tray, 90 Degree Corner, 1857lmm, Recessed, Microprism Diffuser, Grey, End of Run, Colour 84	19.3W	96

When specifying a continuous run system, please ensure that all products within the run are selected from the same output group to ensure the same lit effect throughout your system.

*BSEN 12464 3000 candela compliant variant when used with MP diffuser.

Above luminaire lumen (lmm) figures relate to Opal variant with the exception of L14, L22 & L29 which states Microprism figures.

**BSEN 12464 3000 candela compliant variant when used with MP diffuser.

When used in closed runs corner units only suitable for square and rectangular configurations.

All corner sections are supplied fully assembled with trunking gear tray and diffuser.

Corner units available in black and white finish on request subject to additional lead times.

Where reversed corners are required to achieve the desired configuration these are available on special request. Detailed information of the installation method will be required to ensure we provide the correct solution.

OPTIC

Code	Description
RWY 1000 OP	Runway 1000mm diffuser, Opal
RWY 1500 OP	Runway 1500mm diffuser, Opal
RWY 1000 MP	Runway 1000mm diffuser, Microprism
RWY 1500 MP	Runway 1500mm diffuser, Microprism
RWYR 1000 INFILL TW GY	Runway Recessed 1000mm Infill, Grey, Through Wire
RWYR 1500 INFILL TW GY	Runway Recessed 1500mm Infill, Grey, Through Wire

Trunking Sold Separately

RWY 1000 R24H OP	Runway 1000mm diffuser, R24 sensor, Opal
RWY 1500 R24H OP	Runway 1500mm diffuser, R24 sensor, Opal
RWY 1000 R24H MP	Runway 1000mm diffuser, R24 sensor, Microprism
RWY 1500 R24H MP	Runway 1500mm diffuser, R24 sensor, Microprism
RWY 1000 EA OP	Runway 1000mm diffuser, Easyair sensor, Opal
RWY 1500 EA OP	Runway 1500mm diffuser, Easyair sensor, Opal
RWY 1000 EA MP	Runway 1000mm diffuser, Easyair sensor, Microprism
RWY 1500 EA MP	Runway 1500mm diffuser, Easyair sensor, Microprism

Please specify optic type with all orders.

MP variants compliant with BSEN 12464 3000 candela limit when used with L22 and L14 gear trays.

DIMMING OPTIONS

Code	Description
A	Digital Addressable Lighting Interface (DALI)

S	Switch Dimming
WT	White Tunable, Lumen outputs vary, please contact our sales department for details
C	Bi-Level Dimming for use with standalone switched sensor
D	Digital Dimming (DSI)
H	High Frequency Dimming (Analogue 1-10v)
	Please click here for full details on our white tunable offer

LIGHTING CONTROL

Code	Description
R24H	Reacta 24H, Minihead Daylight and Presence Detection Sensor
EA	Reacta-Air Wireless linking sensor, daylight regulation and presence detection*
RD	Reacta-Dim

*Limitations apply to lumen outputs, please contact our sales department for more information.

Please click here for full details on our wireless controls.

EMERGENCY

Code	Description
E3	3 Hour Integral Emergency
ST3	Self Test
AT3	Autotest Emergency
STR	Emergency Reacta-Link

Emergency is only available in 1500mm variants.

AT3 Emergency can only be combined with DALI Dimming, other dimming types are not available in AT3 Emergency

MISCELLANEOUS

Code	Description
WH	White Finish
BL	Black Finish
RWYR EC 95 GREY	Runway End Cap (Pair)
RWY INSTALL KIT	Runway Installation Kit
C34998 & C3793	1M 6 Pole Blue / Black Lead and Besa Connection Plate
C34997 & C3792	1M 4 Pole Lead and Besa Connection Plate
C34996 & C3791	1M 3 Pole Lead and Besa Connection Plate
C83	Colour 83 (other colours available on request)

Please specify one pair of end caps per continuous run of luminaires.